

# 1000PSI 2PCS Full Port CF8M BALL VALVE



**FIG.# 4E-410C8M16RPT-2F**

**Sizes: 1/4" - 4" @1,000 PSI NSCWP**

2-piece Body, Full Port, Blowout proof stem, Lockable Handle  
NPT Threads Conforms to ANSI B1.20.1, Inspection: API598

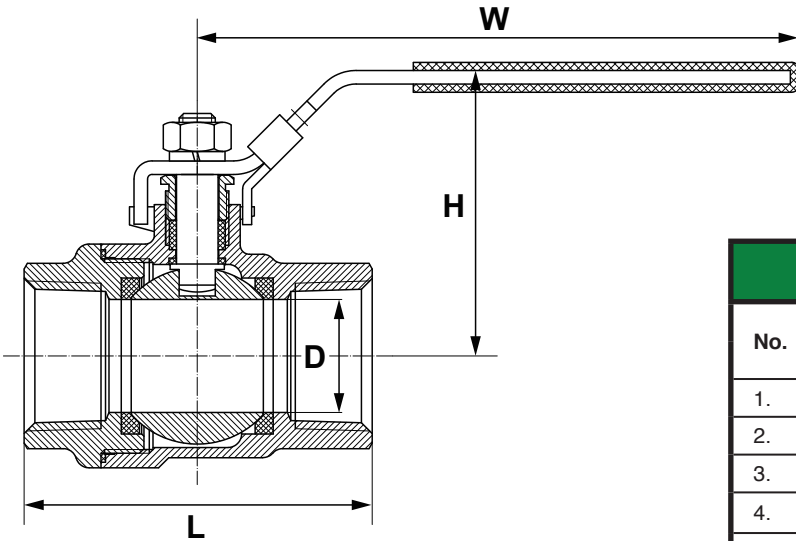
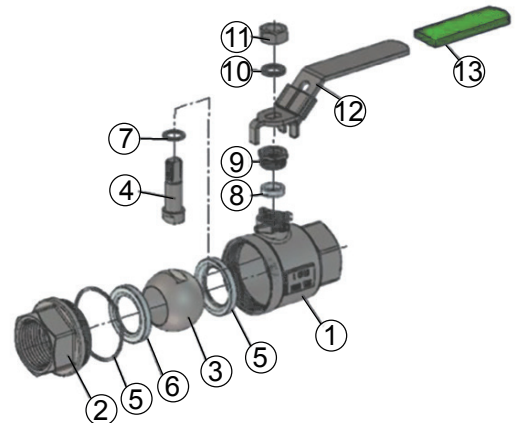

MATERIAL LIST				
No.	Part Name	Material		
		316	304	WCB
1.	Body	A351 - CF8M	A351 - CF8	A216 - WCB
2.	Cap	A351 - CF8M	A351 - CF8	A216 - WCB
3.	Ball	A182 - F316	A182 - F304	A182 - F304
4.	Stem	A276 - 316	A182 - F304	A276 - 304
5.	Seat	PTFE / RPTFE / CTFE		
6.	Cap Gasket	PTFE		
7.	Gasket	PTFE		
8.	Packing	PTFE		
9.	Nut	A182 - 304		
10.	Spring Washer	SS301		
11.	Nut	A2 - 70		
12.	Handle	304		
13.	Handle Cover	PVC		

Due to continuous development of products, weights and measurements are approximate and subject to change without notice.

DIMENSIONS												
SIZE	unit	1/4"	3/8"	1/2"	3/4"	1"	1-1/4"	1-1/2"	2"	2-1/2"	3"	4"
D	mm	12.5	12.5	15.0	20.0	25.0	32.0	38.0	50.0	65.0	76.0	94.0
	inch	0.49	0.49	0.59	0.79	0.98	1.26	1.50	1.97	2.56	2.99	3.70
L	mm	54.6	51.6	63.5	74.0	86.1	98.0	106.0	122.0	159.0	182.1	224.0
	inch	2.03	2.03	2.50	2.91	3.39	3.86	4.17	4.80	6.26	7.17	8.82
H	mm	51.0	51.0	53.0	65.0	77.0	81.5	94.4	102.1	119.1	129.0	169.0
	inch	2.01	2.01	2.09	2.56	3.03	3.21	3.72	4.02	4.69	5.08	6.65
W	mm	103.9	103.9	103.9	126.0	144.0	144.0	189.0	189.0	223.0	223.0	297.9
	inch	4.09	4.09	4.09	4.96	5.67	5.67	7.44	7.44	8.78	8.78	11.73
Weight	kg.	0.21	0.23	0.256	0.39	0.57	1.02	1.35	2.09	4.84	7.73	13.59
	lbs.	0.46	0.51	0.56	0.86	1.26	2.25	2.98	4.61	10.67	17.04	29.96
Max Torque	N·m	4.5	4.5	5.0	6.0	10.0	13.0	19.0	25.0	40.0	65.0	100.0
Min Torque		3.0	3.0	3.5	3.5	7.0	10.0	15.0	20.0	34.0	58.0	75.0

**NOTE:**

- The data of recommended torque are the results of the valves been tested without pressure.
- The data should multiply by a ratio, from **2.2 to 3**, when the valves are equipped with actuators.